

Knurled Head Adjusting Screws
metric

- ▶ Carbon steel, black oxide finish
- ▶ Two-piece construction
- ▶ Straight knurl

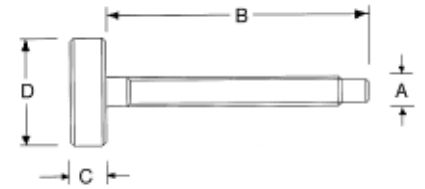

PART #	Thread			D	Tip Dia.	Tip Lgth.
	A	B	C			
KHS-80	M4 x .7	38mm	6mm	19mm	2mm	3mm
KHS-81	M4 x .7	51	6	19	2	3
KHS-82	M6 x 1.0	38	8	25	5	3
KHS-83	M6 x 1.0	51	8	25	5	3
KHS-84	M6 x 1.0	64	8	25	5	3
KHS-85	M8 x 1.25	38	9.5	29	6	5
KHS-86	M8 x 1.25	51	9.5	29	6	5
KHS-87	M8 x 1.25	64	9.5	29	6	5
KHS-88	M10 x 1.5	51	11	32	7	5
KHS-89	M10 x 1.5	64	11	32	7	5
KHS-90	M10 x 1.5	76	11	32	7	5
KHS-91	M12 x 1.75	76	13	32	10	6



Stainless Steel Knurled Head Adjusting Screws
metric

- ▶ 300 series stainless steel
- ▶ Two-piece construction
- ▶ Straight knurl



PART #	Thread			D	C	Tip Dia.	Tip Lgth.
	A	B	D				
KHS-51SS	M4 x .7	32mm	19mm	8mm	2mm	3mm	
KHS-52SS	M4 x .7	41	19	8	2	3	
KHS-53SS	M4 x .7	51	19	8	2	3	
KHS-54SS	M6 x 1.0	25	25	8	4	3	
KHS-55SS	M6 x 1.0	38	25	8	4	3	
KHS-56SS	M6 x 1.0	51	25	8	4	3	
KHS-57SS	M6 x 1.0	64	25	8	4	3	
KHS-58SS	M8 x 1.25	25	29	9.5	6	4	
KHS-59SS	M8 x 1.25	38	29	9.5	6	4	
KHS-60SS	M8 x 1.25	44	29	9.5	6	4	
KHS-61SS	M8 x 1.25	57	29	9.5	6	4	
KHS-62SS	M8 x 1.25	70	29	9.5	6	4	
KHS-63SS	M8 x 1.25	76	29	9.5	6	4	
KHS-64SS	M10 x 1.5	38	32	11	7	4	
KHS-65SS	M10 x 1.5	51	32	11	7	4	
KHS-66SS	M10 x 1.5	64	32	11	7	4	
KHS-67SS	M10 x 1.5	76	32	11	7	4	
KHS-68SS	M10 x 1.5	89	32	11	7	4	
KHS-69SS	M10 x 1.5	102	32	11	7	4	
KHS-70SS	M12 x 1.75	64	32	13	10	6	
KHS-71SS	M12 x 1.75	70	32	13	10	6	
KHS-72SS	M12 x 1.75	76	32	13	10	6	
KHS-73SS	M12 x 1.75	89	32	13	10	6	

